

# Lead Screw

Linear actuation for positioning tasks  
PRECiStep® Technology

For combination with  
Stepper Motors: ADM0620, AM0820, AM1020

## Series M1,6 x 0,35 x L1

Nominal diameter	1,6	mm
Pitch	0,35	mm
Material	Stainless steel	

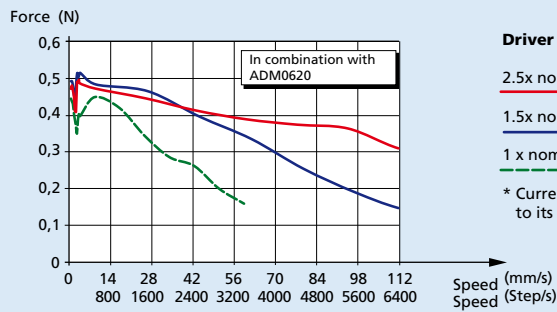

**Driver settings**  
 2.5x nominal voltage \*  
 1.5x nominal voltage \*  
 1 x nominal voltage  
 \* Current limited to its nominal value

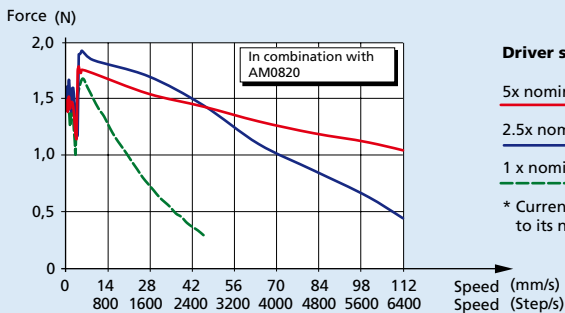

**Driver settings**  
 5x nominal voltage \*  
 2.5x nominal voltage \*  
 1 x nominal voltage  
 \* Current limited to its nominal value

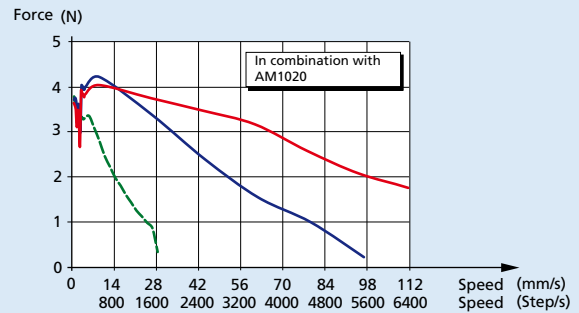

**Important notes:** The thrust curves include already a safety factor for the use of the stepper motor.  
Please read the "Technical information" for a better understanding of the curves.

Ordering information	L1 (mm) =	7,5	15	25	Custom
Order code (no bearing tip)		M1,6x0,35x7,5	M1,6x0,35x15	-	M1,6x0,35xL1*
Order code (with bearing tip)		-	M1,6x0,35x15T	M1,6x0,35x25T	M1,6x0,35xL1*T

\* For custom length, please inquire with your point of sales

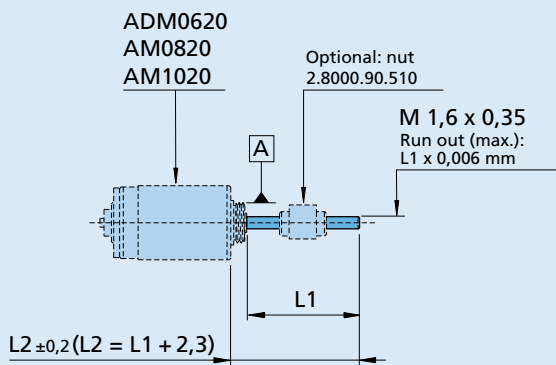

**M1,6 x 0,35 x L1**

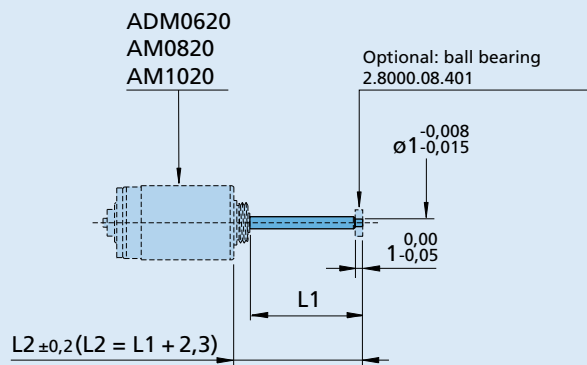

Version with bearing tip  
**M1,6 x 0,35 x L1 T**

# Lead Screw

Optional nuts and bearings  
PRECIstep® Technology

## Options

For M1,2 x 0,25 Lead screws

Scale 2:1 

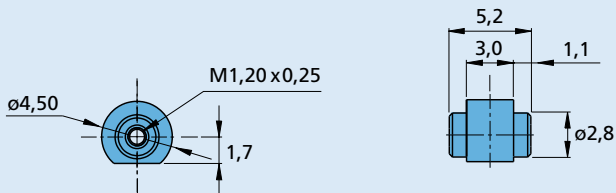

Nut Part No. 2.8000.08.351, Material CuAl10Ni5Fe4

For M1,6 x 0,35 Lead screws

Scale 2:1 

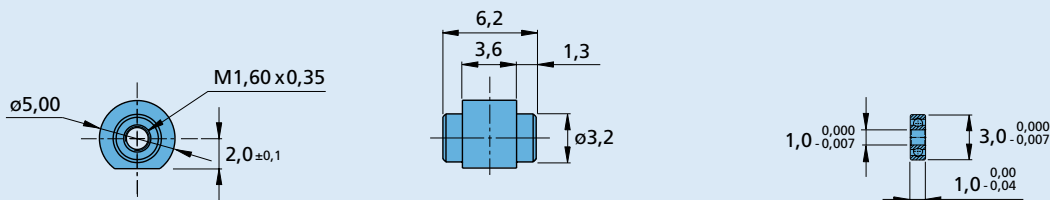

Nut Part No. 2.8000.90.510, Material CuAl10Ni5Fe4

Bearing for leadscrew tip Part No. 2.8000.08.401

For M2,0 x 0,2 Lead screws

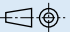
Scale 2:1 

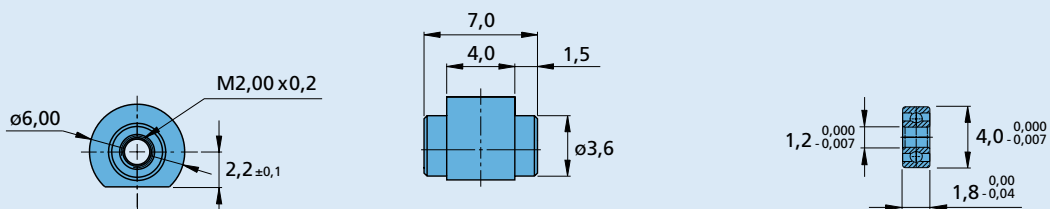

Nut Part No. 2.8000.08.353, Material CuAl10Ni5Fe4

Bearing for leadscrew tip Part No. 2.8000.10.401

For M2,5 x 0,25 Lead screws

Scale 2:1 

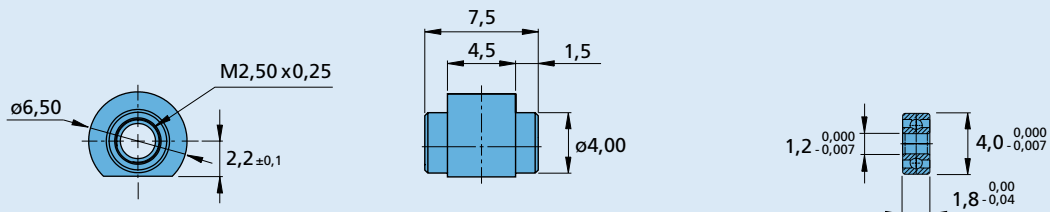

Nut Part No. 2.8000.90.511, Material CuAl10Ni5Fe4

Bearing for leadscrew tip Part No. 2.8000.10.401

For M3,0 x 0,5 Lead screws

Scale 2:1 

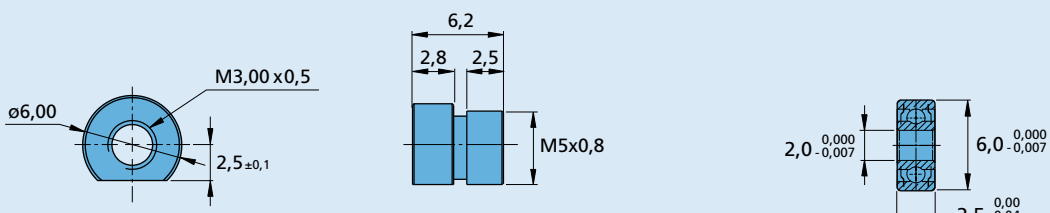

Nut Part No. 2.8000.90.531, Self-lubricating synthetic material

Bearing for leadscrew tip Part No. 2.8000.22.450